

# Installation Instructions

1. Place the trim parts against the assigned wall location. Make sure that the ring is leveled. Mark the ring post flange position and remove the trim.

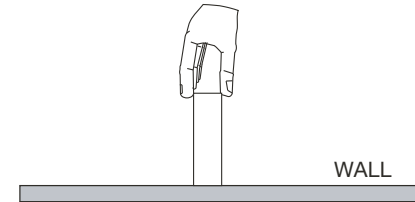

2. Using the Allen key provided, remove the mounting post from the ring post. Press the mounting post against ring post position on the wall and mark the screw hole positions.

NOTE: MAKE SURE THE ALLEN SCREW HOLE ON THE MOUNTING POST IS FACING DOWN WHEN SECURING TO WALL.

## INSTALLING ON WOODEN SURFACE

For wooden surface, the mounting post can be secured by screwing the screws directly into the wall.

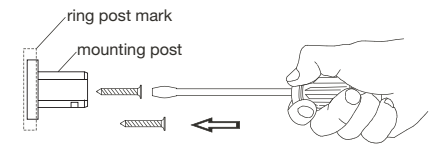

## INSTALLING ONTO DRYWALL SURFACE

Using a drill, pre-drill holes for the anchors. Insert the anchors into the wall. The mounting post can be secured by screwing the screws into the anchors.

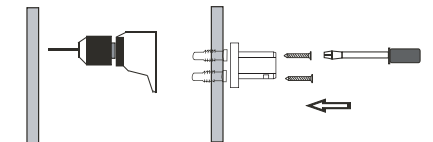

## INSTALLING ONTO A SOLID SURFACE

Measure the dimensions carefully. Using a drill, pre-drill the holes. Secure the mounting post by screwing the screws into the wall.

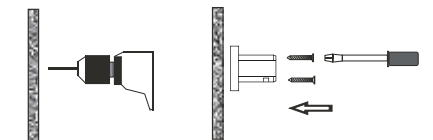

# Installation Instructions

---

3. Press the ring post against the mounting post. Align the ring post and secure it by tightening the set screw.
4. Check the ring post to make sure it is firmly secured. If not, tighten the set screw with the Allen key.

